

PGF064-L2

输出端/OUTPUT

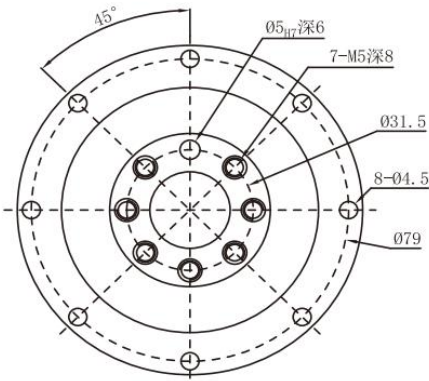

输入端/INPUT

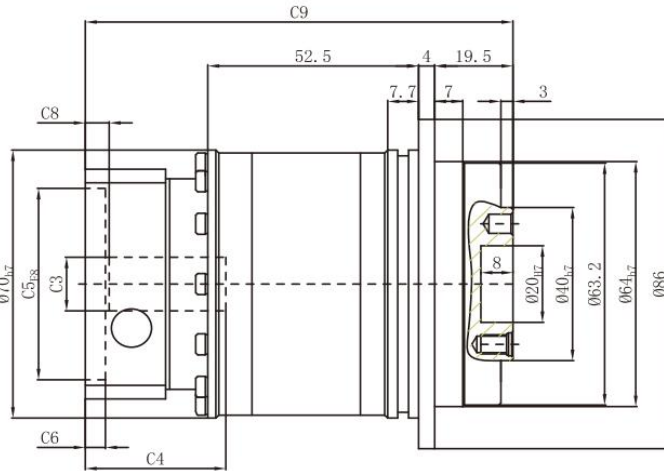
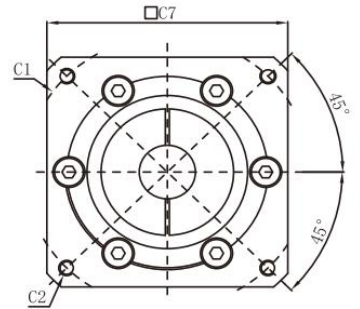

尺寸	C1	C2	C3	C4	C5	C6	C7	C8	C9
PGF064-L1	$\phi 46$	4-M4x10	$\leq \phi 8$	35	$\phi 30$	5	60	5.5	79.5
	$\phi 66.7$	4-M4x10	$\leq \phi 8$	35	$\phi 38.1$	5	60	5.5	79.5
	$\phi 70$	4-M4x10,4-M5x10	$\leq \phi 14$	35	$\phi 50$	5	60	5.5	79.5
	$\phi 75$	4-M4x10,4-M5x10	$\leq \phi 14$	35	$\phi 60$	5	66	5.5	79.5
PGF064-L2	$\phi 46$	4-M4x10	$\leq \phi 8$	35	$\phi 30$	5	60	5.5	106.5
	$\phi 66.7$	4-M4x10	$\leq \phi 8$	35	$\phi 38.1$	5	60	5.5	106.5
	$\phi 70$	4-M4x10,4-M5x10	$\leq \phi 14$	35	$\phi 50$	5	60	5.5	106.5
	$\phi 75$	4-M4x10,4-M5x10	$\leq \phi 14$	35	$\phi 60$	5	66	5.5	106.5

* C1~C9 是公制标准马达连接板之尺寸,可根据客户要求单独定做。

* C1~C9 are motor (metric standard) specific dimensions, which could be customised.

外形尺寸图表 / OUTLINE DIMENSION SHEET

PGF090-L1

输出端/OUTPUT

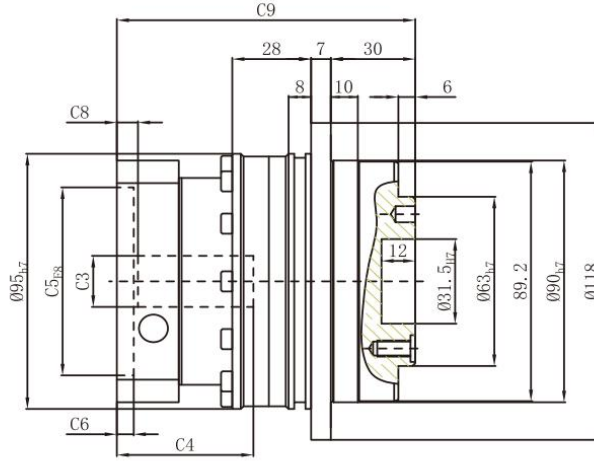
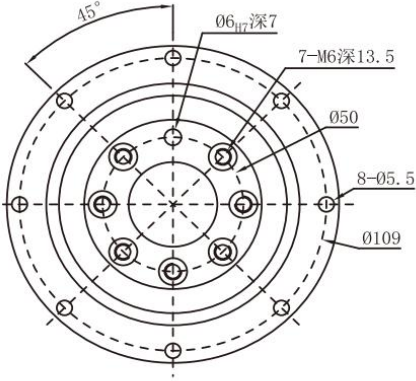

输入端/INPUT

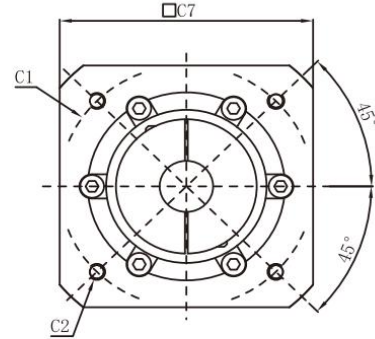

PGF090-L2

输出端/OUTPUT

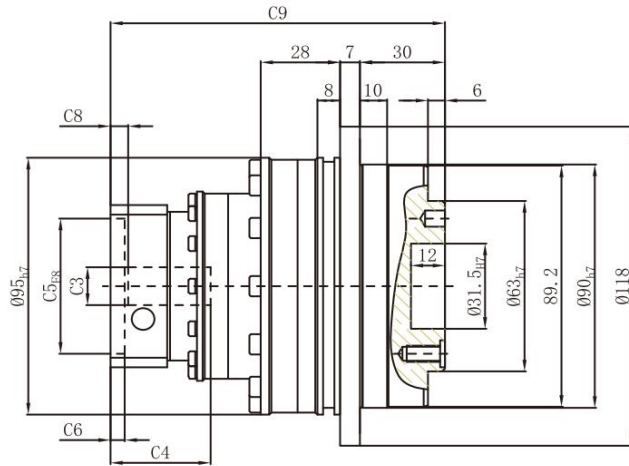
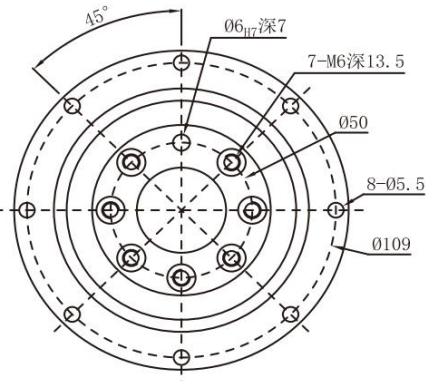

输入端/INPUT

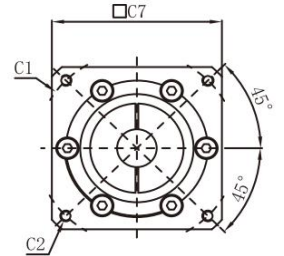

尺寸	C1	C2	C3	C4	C5	C6	C7	C8	C9
PGF090-L1	φ 90	4-M5x15,4-M6x15	≦ φ 24	47	φ 70	6	90	7	106
	φ 98.4	4-M5x15,4-M6x15	≦ φ 14	47	φ 73	6	90	7	106
	φ 100	4-M6x15	≦ φ 24	47	φ 80	6	90	7	106
	φ 115	4-M6x20,4-M8x20	≦ φ 24	59	φ 95	11	100	19	118
	φ 130	4-M8x20	≦ φ 24	59	φ 95	11	115	19	118
	φ 145	4-M8x20	≦ φ 24	59	φ 110	11	130	19	118
	φ 145	4-M8x20	≦ φ 24	70	φ 110	11	130	30	129
PGF090-L2	φ 70	4-M4x10,4-M5x10	≦ φ 14	35	φ 50	5	60	5.5	118
	φ 90	4-M5x15,4-M6x15	≦ φ 24	47	φ 70	6	90	7	139.5
	φ 98.4	4-M5x15,4-M6x15	≦ φ 14	47	φ 73	6	90	7	139.5
	φ 100	4-M6x15	≦ φ 24	47	φ 80	6	90	7	139.5
	φ 115	4-M6x20,4-M8x20	≦ φ 24	59	φ 95	11	100	19	151.5
	φ 130	4-M8x20	≦ φ 24	59	φ 95	11	115	19	151.5
	φ 145	4-M8x20	≦ φ 24	59	φ 110	11	130	19	151.5
φ 145	4-M8x20	≦ φ 24	70	φ 110	11	130	30	162.5	

* C1~C9 是公制标准马达连接板之尺寸,可根据客户要求单独定做。

* C1~C9 are motor (metric standard) specific dimensions, which could be customised.

外形尺寸图表 / OUTLINE DIMENSION SHEET

PGF110-L1

输出端/OUTPUT

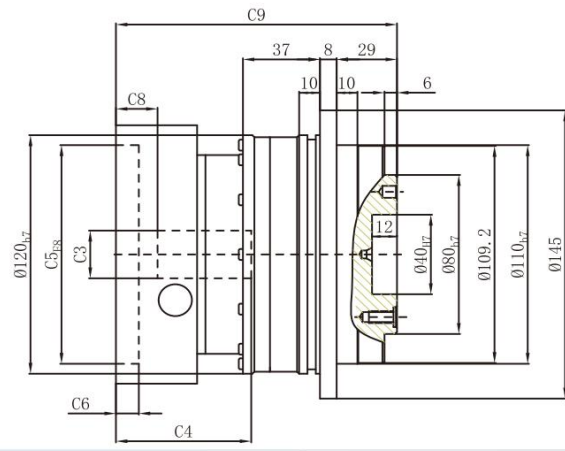
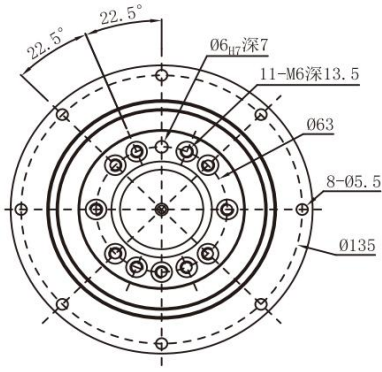

输入端/INPUT

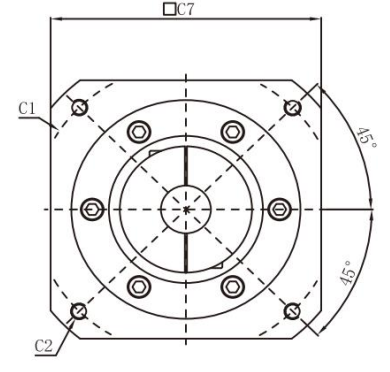

PGF110-L2

输出端/OUTPUT

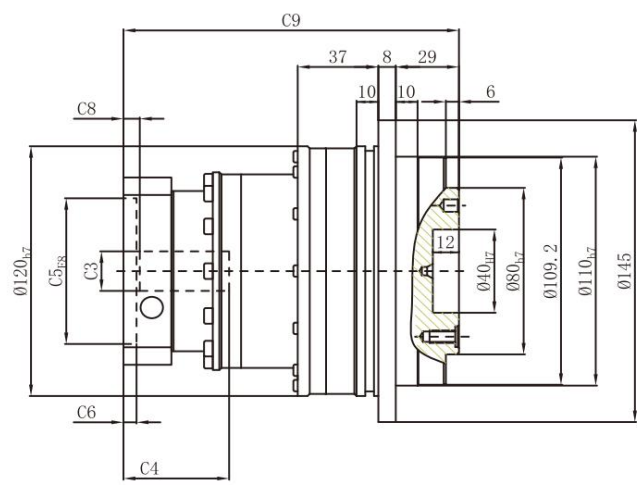
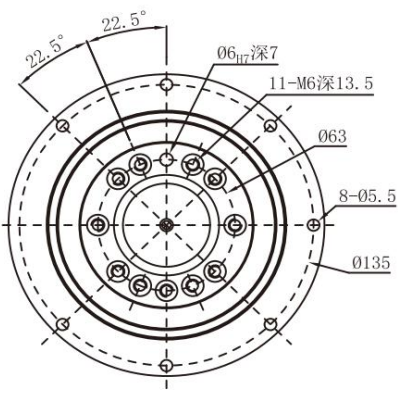

输入端/INPUT

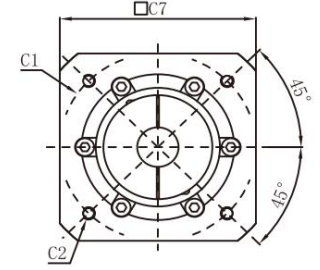

尺寸	C1	C2	C3	C4	C5	C6	C7	C8	C9
PGF110-L1	φ 115	4-M6x20,4-M8x20	≤ φ 24	61	φ 95	11	115	17	132
	φ 130	4-M8x20	≤ φ 24	61	φ 95	11	115	17	132
	φ 145	4-M8x20	≤ φ 24	64	φ 110	11	130	19	135
	φ 145	4-M8x20	≤ φ 24	71	φ 110	11	130	26	142
PGF110-L2	φ 90	4-M5x15,4-M6x15	≤ φ 19	47	φ 70	6	90	7	154
	φ 115	4-M8x20	≤ φ 24	59	φ 95	11	115	19	166
	φ 130	4-M8x20	≤ φ 24	59	φ 95	11	115	19	166
	φ 145	4-M8x20	≤ φ 24	59	φ 110	11	130	19	166
	φ 145	4-M8x20	≤ φ 24	70	φ 110	11	130	30	177

* C1~C9 是公制标准马达连接板之尺寸,可根据客户要求单独定做。
 * C1~C9 are motor (metric standard) specific dimensions, which could be customised.

外形尺寸图表 / OUTLINE DIMENSION SHEET

PGF140-L1

输出端/OUTPUT

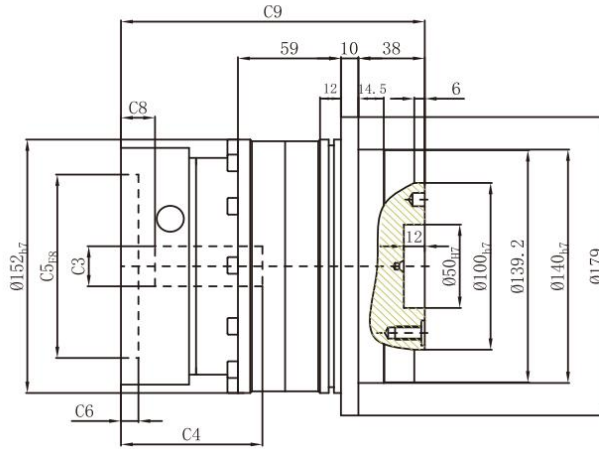
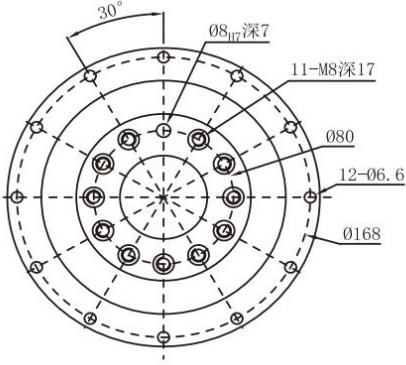

输入端/ INPUT

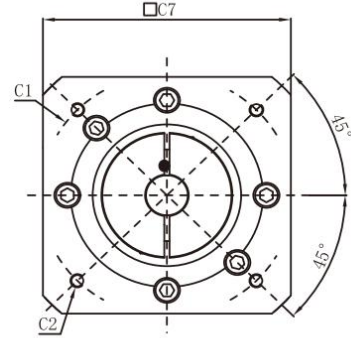

PGF140-L2

输出端/OUTPUT

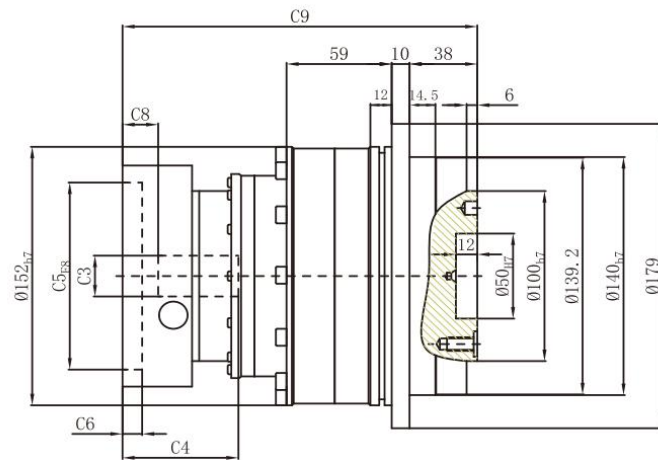
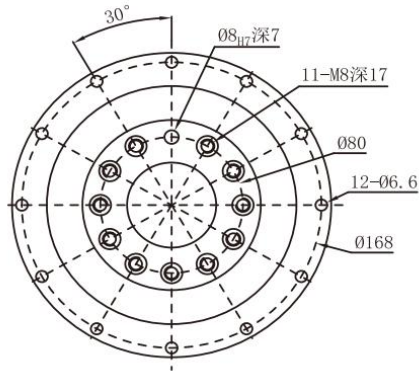

输入端/ INPUT

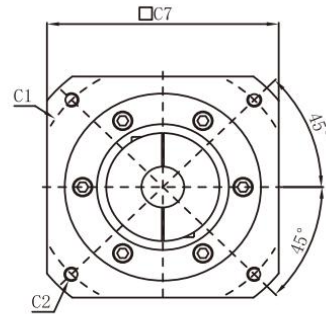

尺寸	C1	C2	C3	C4	C5	C6	C7	C8	C9
PGF140-L1	φ 145	4-M8x20	≤ φ 24	81	φ 110	10	142	19.5	174
	φ 165	4-M10x30	≤ φ 28	81	φ 130	10	142	19.5	174
	φ 200	4-M12x35	≤ φ 42	83	φ 114.3	8	180	21.5	176
PGF140-L2	φ 145	4-M8x25	≤ φ 24	65	φ 110	11	142	20	199
	φ 165	4-M10x30	≤ φ 28	65	φ 130	10	142	20	199
	φ 200	4-M12x35	≤ φ 42	83	φ 114.3	8	180	21.5	239.5

* C1~C9 是公制标准马达连接板之尺寸,可根据客户要求单独定做。

* C1~C9 are motor (metric standard) specific dimensions, which could be customised.

外形尺寸图表 / OUTLINE DIMENSION SHEET

PGF200-L1

输出端/OUTPUT

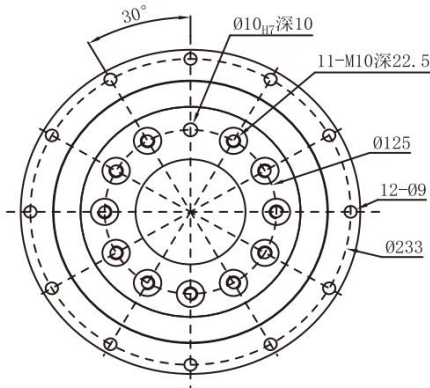

输入端/INPUT

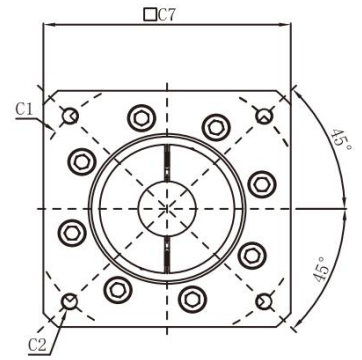
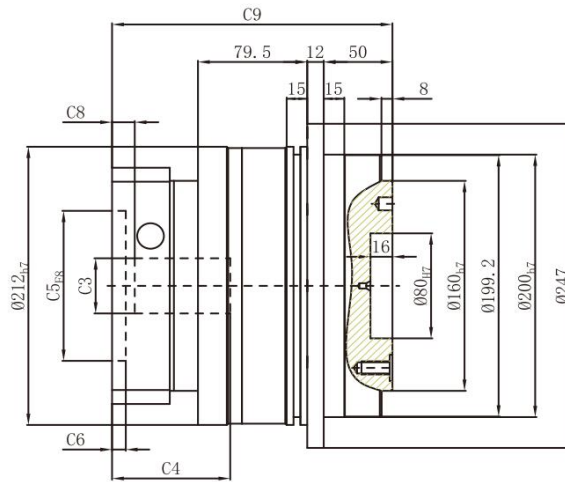

PGF 200-L2

输出端/OUTPUT

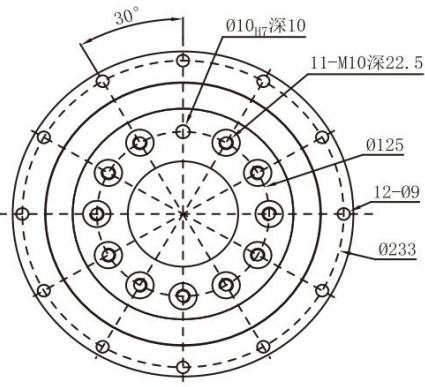

输入端/INPUT

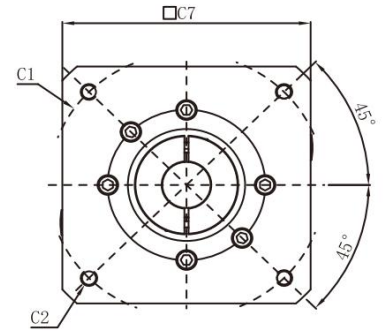
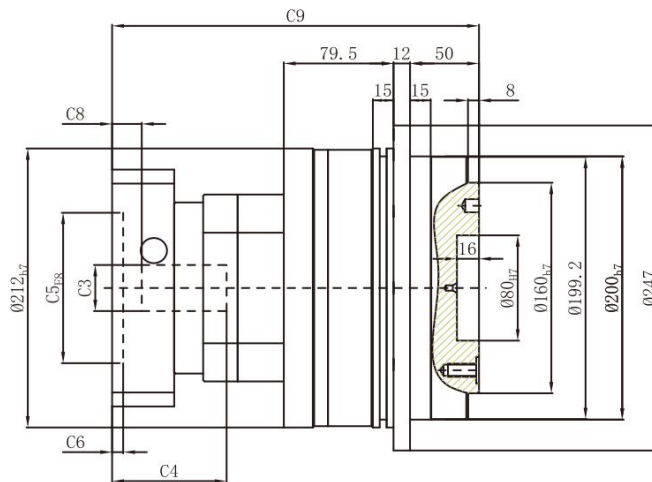

尺寸	C1	C2	C3	C4	C5	C6	C7	C8	C9
PGF 200-L1	φ 165	4-M10x25	≤ φ 32	86	φ 30	10	180	16.5	204
	φ 200	4-M12x35	≤ φ 42	86	φ 114.3	10	180	16.5	204
	φ 200	4-M12x35	≤ φ 42	118	φ 114.3	10	180	48.5	236
	φ 215	4-M12x35, 4-M14x35	≤ φ 42	86	φ 180	10	190	16.5	204
	φ 235	4-M10x30, 4-M14x35	≤ φ 55	118	φ 200	10	220	48.5	236
PGF 200-L2	φ 145	4-M8x20	≤ φ 24	81	φ 110	10	142	19.5	264
	φ 165	4-M10x30	≤ φ 28	81	φ 130	10	142	19.5	264
	φ 200	4-M12x35	≤ φ 42	83	φ 114.3	8	180	21.5	266
	φ 200	4-M12x35, 4-M14x35	≤ φ 42	115	φ 114.3	8	180	53.5	298
	φ 215	4-M14x35	≤ φ 42	83	φ 180	8	190	21.5	266

* C1~C9 是公制标准马达连接板之尺寸,可根据客户要求单独定做。

* C1~C9 are motor (metric standard) specific dimensions, which could be customised.

外形尺寸图表 / OUTLINE DIMENSION SHEET

PGF255-L1

输出端/OUTPUT

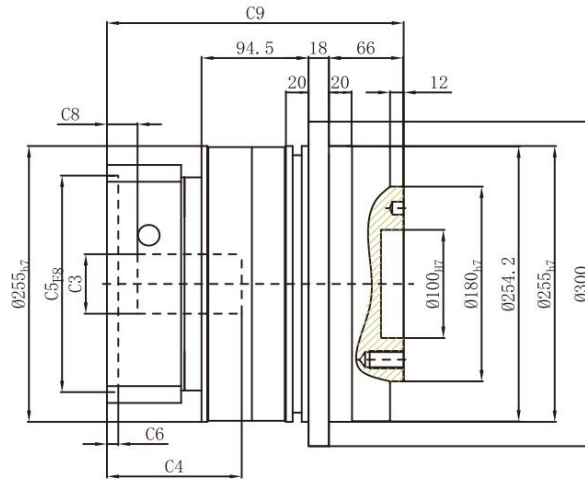
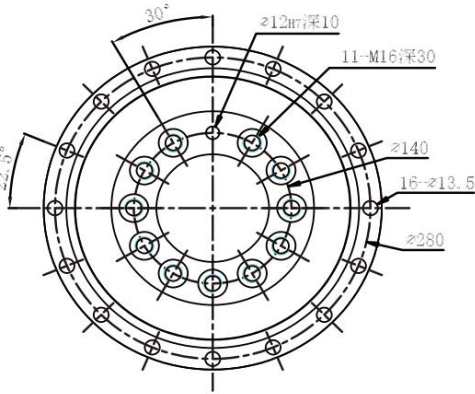

输入端/INPUT

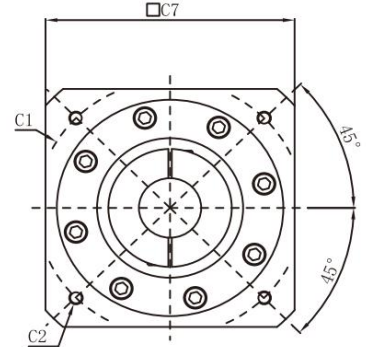

PGF255-L2

输出端/OUTPUT

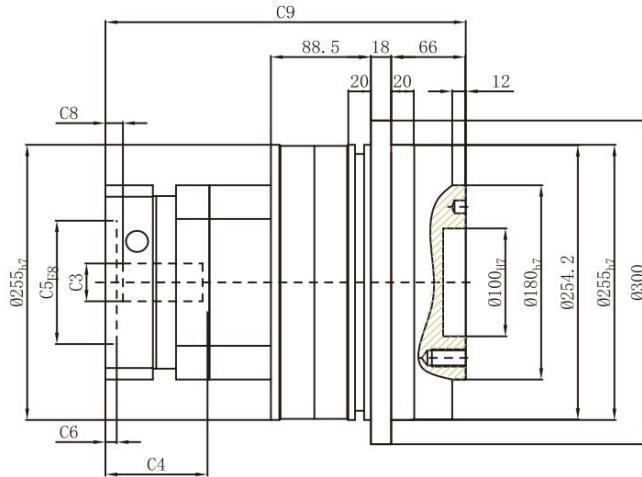
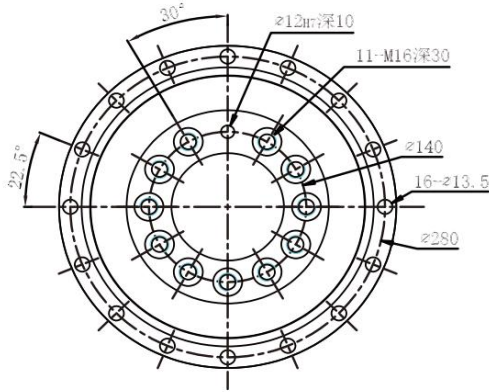

输入端/INPUT

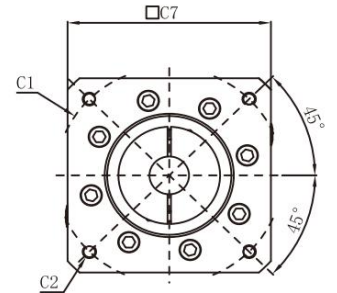

尺寸	C1	C2	C3	C4	C5	C6	C7	C8	C9
PGF255-L1	φ 200	4-M12x35	≤ φ 42	119	φ 114.3	10	220	27	262
	φ 215	4-M14x35	≤ φ 42	119	φ 180	10	220	27	262
	φ 235	4-M12x35, 4-M14x35	≤ φ 55	119	φ 200	10	220	27	262
PGF255-L2	φ 165	4-M10x25, 4-M12x35	≤ φ 32	118	φ 130	10	180	16.5	319
	φ 200	4-M12x35	≤ φ 42	118	φ 114.3	10	180	16.5	319
	φ 215	4-M12x35, 4-M14x35	≤ φ 42	118	φ 180	10	190	16.5	319
	φ 235	4-M12x35, 4-M14x35	≤ φ 55	150	φ 200	10	220	48.5	351

* C1~C9 是公制标准马达连接板之尺寸,可根据客户要求单独定做。

* C1~C9 are motor (metric standard) specific dimensions, which could be customised.